

# D C Norris & Company

At the forefront of food handling and process technology

## Flush Fitting Outlet Valve

DCN 3" Flush Fitting Outlet Valve designed to provide automated product discharge from kettles and storage vessels.

- EHEDG approved design
- FDA approved seal material
- Automated operation
- Easily removable for cleaning and servicing
- Can be integrated into CIP systems
- Crevice free design
- 3" or 4" sizes available



Tested by the Campden & Chorleywood Food Research Association Group in order to gain EHEDG approval, thus ensuring that the valve is fully suitable for use in hygienic clean-in-place applications.

It has been designed to facilitate automated product discharge from kettles and storage vessels.

**DCN On-Site Test Kitchen Facility Available for Product Development, Trials & Hire**

**Book Your Trial Now!**



**For further details and for the full range of DCN food processing equipment contact:**

Sales Office, D C Norris & Company Ltd,

Tel: +44 (0)1767 677 515 Fax: +44 (0) 1767 677956

Email: [sales@dcnorris.co.uk](mailto:sales@dcnorris.co.uk)

Or visit our web-site [www.dcnorris.co.uk](http://www.dcnorris.co.uk)

# D C Norris & Company

At the forefront of food handling and process technology

## Technical Data

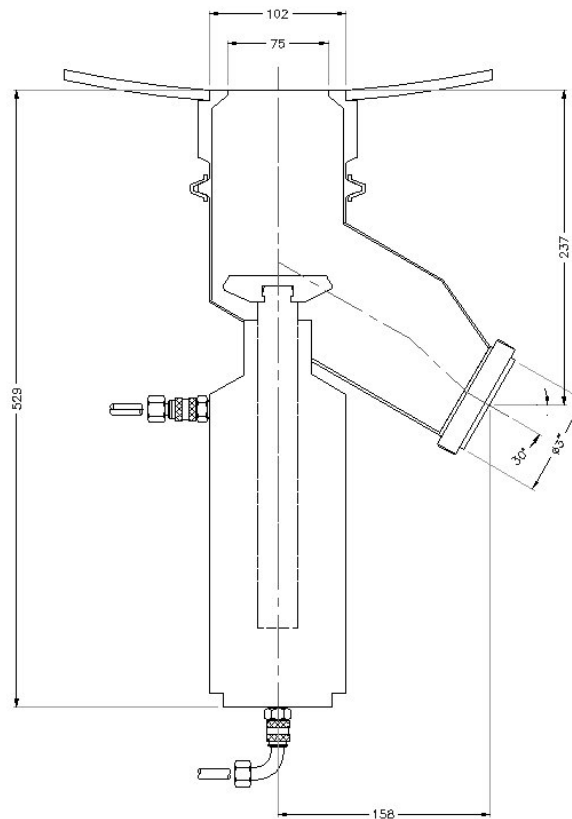

	Requirement	Connection
Compressed Air	600 l/min @ 6 Bar	8 mm
Product Inlet – 3" / 4"		75 mm / 100 mm
Product Outlet – 3" / 4"		3" / 4" IDF Hygienic Fitting

Discharge Angle	Discharge Point	Length	Weight (Kg)
30° to the horizontal	158 mm from centre 237 mm below inlet	529 mm	

**DCN On-Site Test Kitchen Facility Available for Product Development, Trials & Hire**

**Book Your Trial Now!**



**For further details and for the full range of DCN food processing equipment contact:**

Sales Office, D C Norris & Company Ltd,

Tel: +44 (0)1767 677 515 Fax: +44 (0) 1767 677956

Email: [sales@dcnorris.co.uk](mailto:sales@dcnorris.co.uk)

Or visit our web-site [www.dcnorris.co.uk](http://www.dcnorris.co.uk)