

D C Norris & Company

At the forefront of food handling and process technology

Skeleton Conveyor

Used for the transportation of product casings e.g from a Pump Fill Station to a Tumble Chiller.

- All stainless steel tubular design
- Various options
- Inclined
- Flat
- Trough
- Plastic panel
- Quick release belt
- 2,000 mm to 10,000 mm
- Other size on request
- Easy clean
- Optional speeds
- Self tensioning belt
- Lift off side guides
- No nuts or bolts
- IP 65
- Drop on side tables (*optional*)
- Integral start stop
- Variable speed (*optional*)



The D C Norris Skeleton conveyors are stainless steel construction and available in various options. The new patented belt release keeps down time to a minimum, and with a totally open tubular frame cleaning time is also kept to minimum making it one of the most hygienic conveyors available.

DCN On-Site Test Kitchen Facility Available for Product Development, Trials & Hire used for the transportation of product casings from a Pump Fill Station to a Tumble Chiller.



For further details and for the full range of DCN food processing equipment contact:

Sales Office, D C Norris & Company Ltd,

Tel: +44 (0)1767 677 515 Fax: +44 (0) 1767 677956

Email: sales@dcnorris.co.uk

Or visit our web-site www.dcnorris.co.uk

D C Norris & Company

At the forefront of food handling and process technology

Technical Data

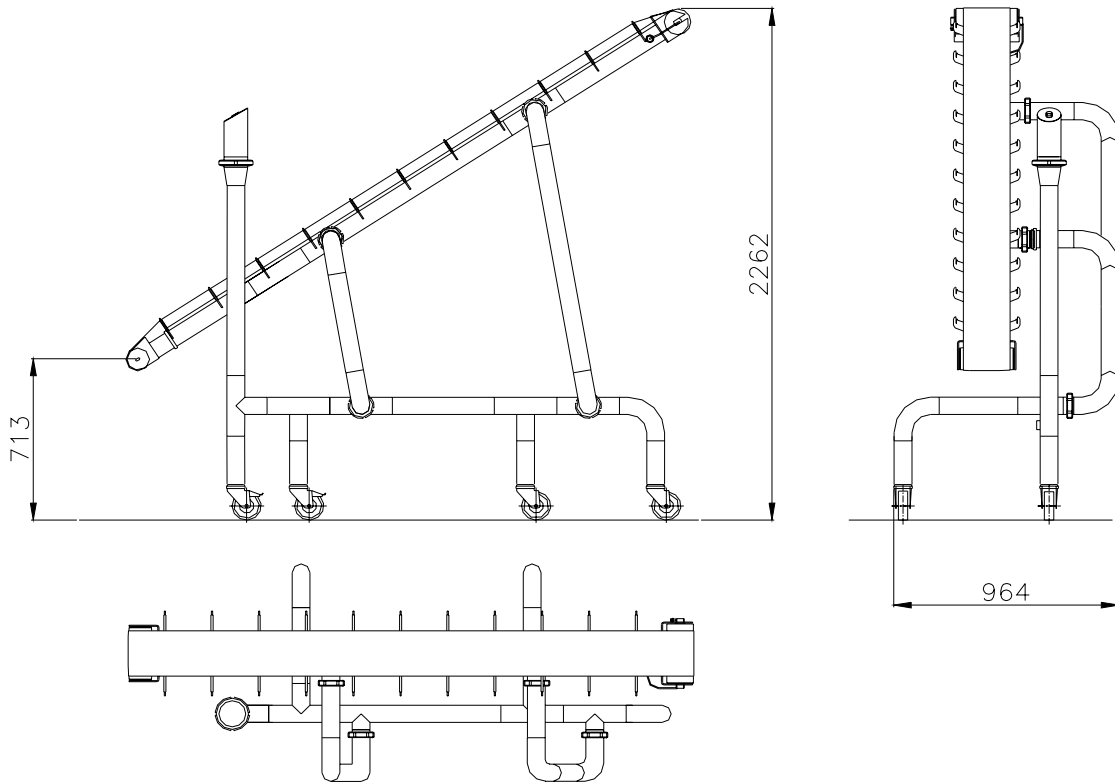

Please note all sizes can be changed to suit customer requirements

	Requirement	Connection
Voltage	400 VAC - 2.5A	20mm

Height	Width	Length	Weight (Kg)
2262	Customer dependent	Customer dependent	150

DCN On-Site Test Kitchen Facility Available for Product Development, Trials & Hire

Book Your Trial Now!



For further details and for the full range of DCN food processing equipment contact:

Sales Office, D C Norris & Company Ltd,

Tel: +44 (0)1767 677 515 Fax: +44 (0) 1767 677956

Email: sales@dcnorris.co.uk

Or visit our web-site www.dcnorris.co.uk